

Construction Sequence (Phase 1)

I-66 Eastbound Widening - Phase 1A

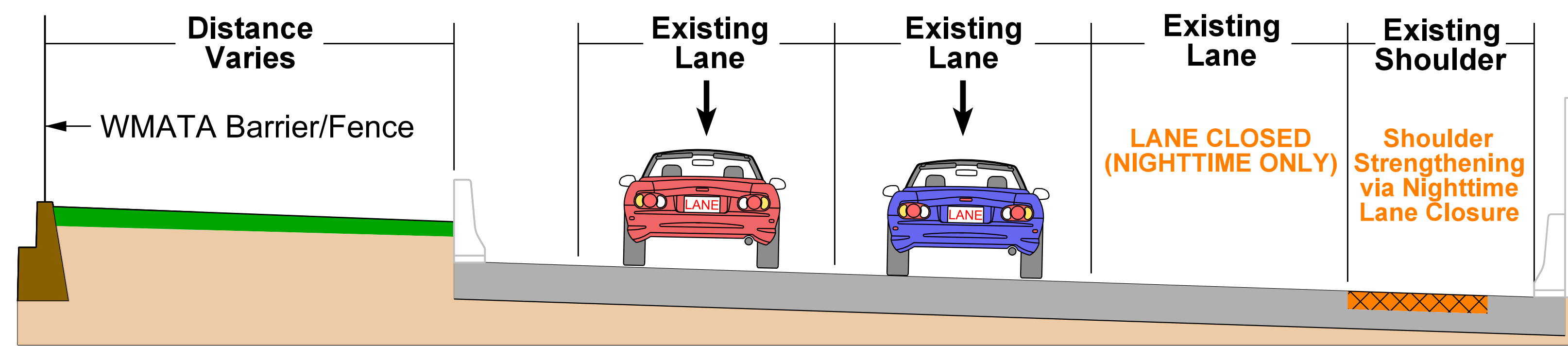

Existing 3 Lane Segment (Project Beginning to N. Sycamore St.)

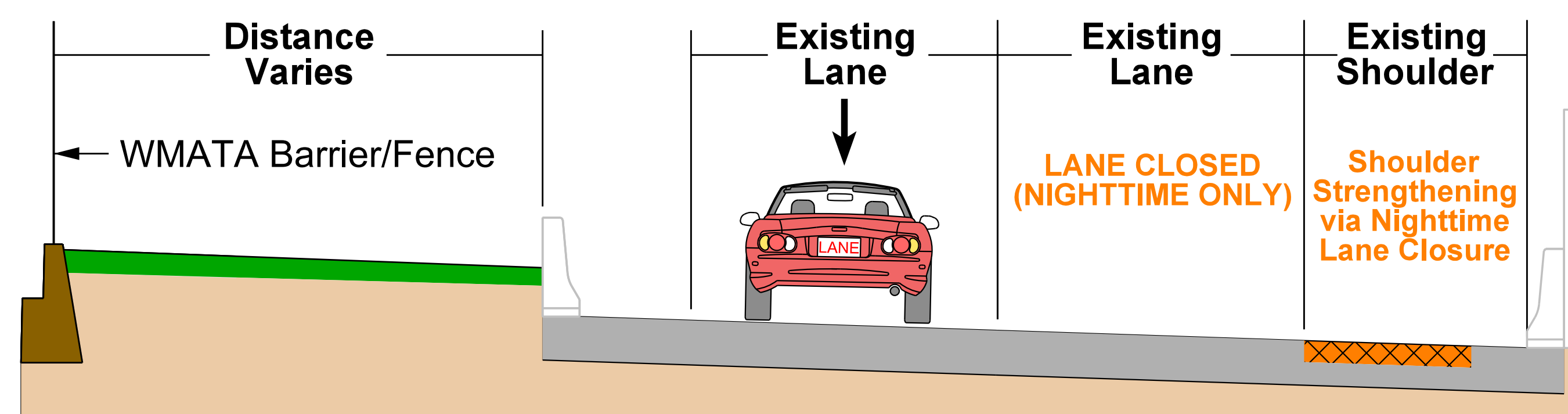

Existing 2 Lane Segment (N. Sycamore St. to Project End)

- Summer 2018
- Nighttime lane closures only

I-66 Eastbound Widening - Phase 1B

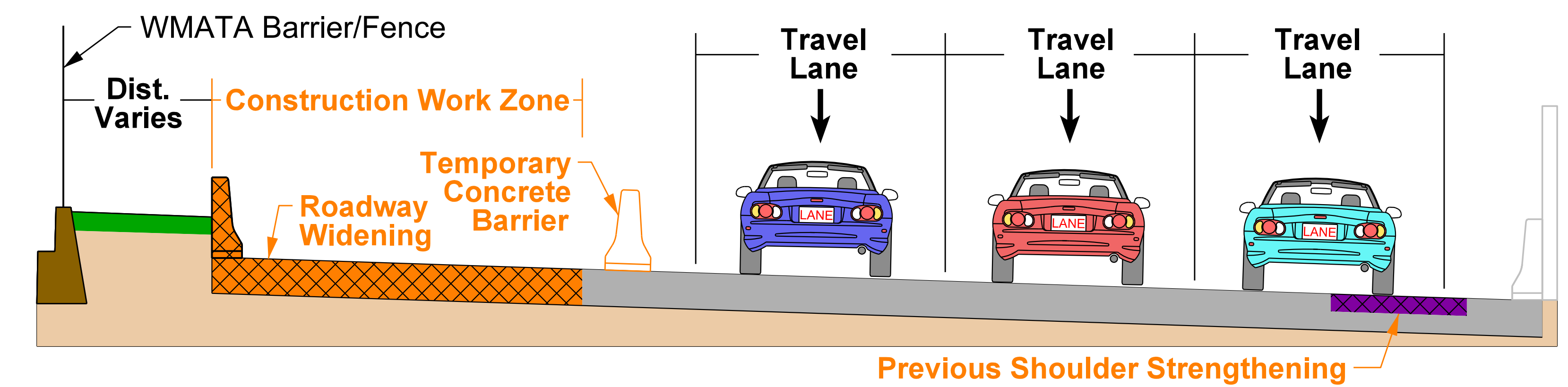

Existing 3 Lane Segment (Project Beginning to N. Sycamore St.)

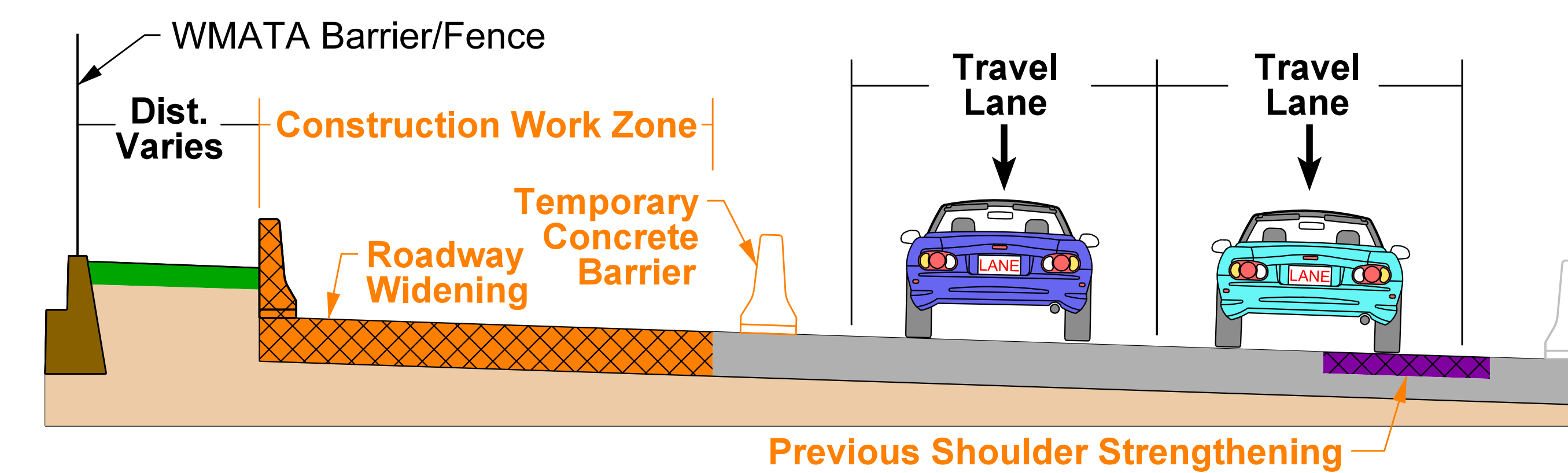

Existing 2 Lane Segment (N. Sycamore St. to Project End)

- Summer 2018 - Summer 2019
- Work behind temporary concrete barrier
- Primarily daytime operations without lane closures
- Nighttime lane closures as needed